

EXPLODED VIEWS

1. MAIN UNIT SECTION

NOTES) THE EXCLAMATION POINT WITHIN AN EQUILATERAL TRIANGLE IS INTENDED TO ALERT THE SERVICE PERSONNEL TO THE PRESENCE OF IMPORTANT SAFETY INFORMATION IN SERVICE LITERATURE.

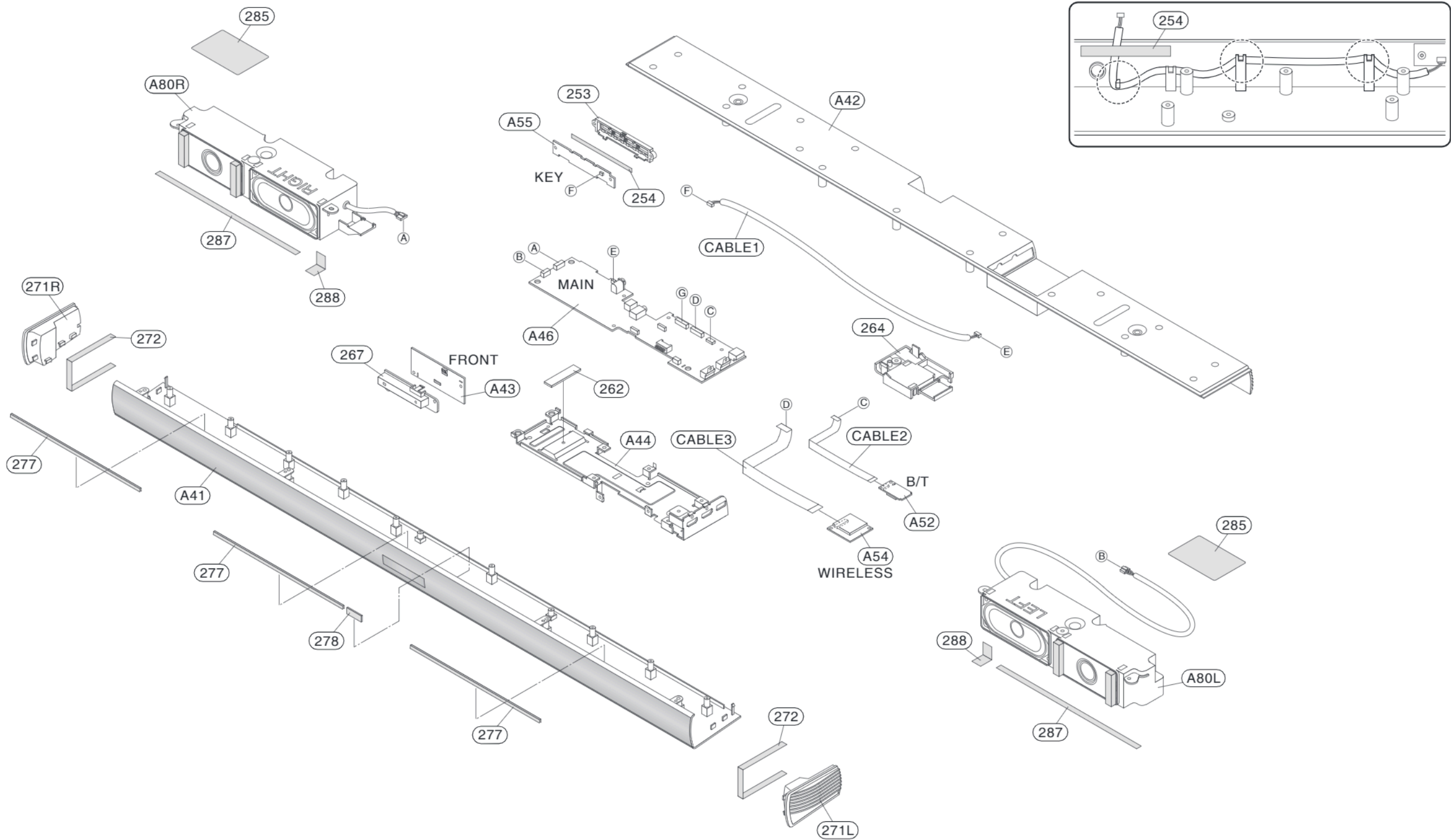

2. WIRELESS SUBWOOFER SECTION

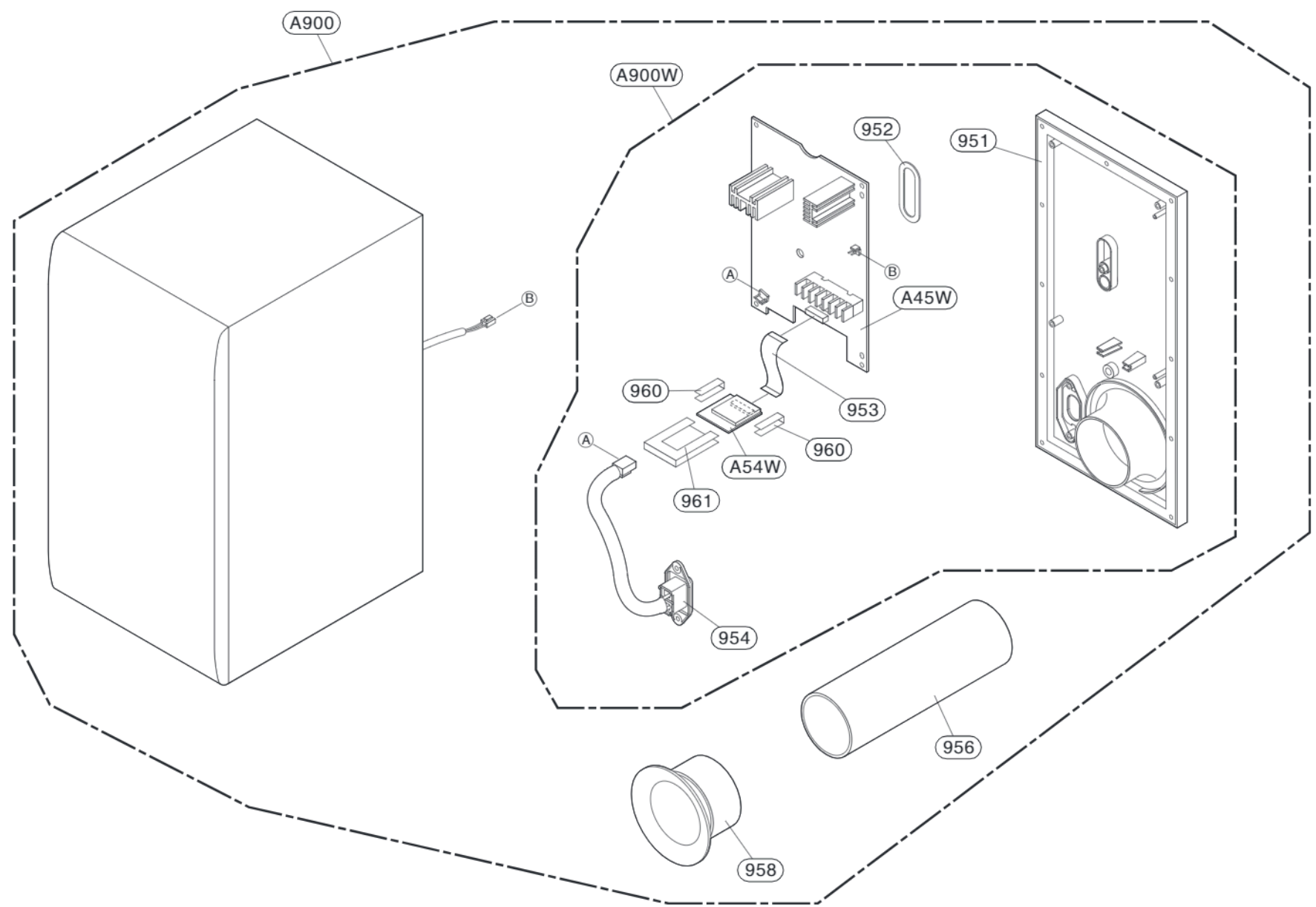

3. PACKING ACCESSORY SECTION

★Optional Part

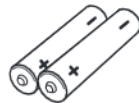
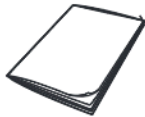

806 Optical cable



900 Remote control

833 AC adapter



300 Power cord

835 Wall bracket



836 Screws (2)

